

FASPLINT HALFBACK®

APPLICATION GUIDELINES



Model Number:
FSH 1000
FSH 1500
FSH 3000

INTRODUCTION

The purpose of the FASPLINT HALFBACK® is to provide both stabilization and comfort for patients during transport. A variety of patient handling devices, like the CombiCarrierII®, may be used with the FASPLINT HALFBACK. Unlike a conventional backboard, the FASPLINT HALFBACK utilizes vacuum technology to conform to the exact shape and contours of the patient's body, providing improved lateral and axial motion restriction and eliminating the discomfort of pressure points associated with traditional spine immobilization. The FASPLINT HALFBACK provides stabilization of the patient's head, neck and torso as one unit.

Practical "hands-on" training is required prior to the use of this medical device. If you become aware of any serious incident related to the use of the device, you should report the incident to Hartwell Medical and to your medical device regulatory authority. If there are any questions, or if additional technical support is required, contact your local Hartwell Medical Distributor or Hartwell Medical Customer Service between the hours of 7:30 am to 4:30 pm Pacific Time, Monday through Friday, at 760-438-5500.

These Application Guidelines are written on the premise that the user of this medical device has received approved emergency medical service training and certification, and is operating under physician medical control and protocols.



FASPLINT HALFBACK®

APPLICATION GUIDELINES

PREPARATION

1. Lay the FASPLINT HALFBACK® splint out on a flat surface near the patient. The “head and shoulder” logo indicates the head end of the splint.
2. Remove the red vinyl leashed cap from the MaxiValve™. Release any vacuum in the splint by pushing in the red valve stem. Keep the valve stem pushed in until the splint is pliable.
3. Manually smooth out the beads to form a level surface.
4. Connect the pump to the splint by fastening the pump hose connector to the valve on the splint. A portable suction unit can also be used to evacuate the splint.
5. Evacuate enough air to make the splint semi-rigid.

The objective is to be able to move the FASPLINT HALFBACK as a unit during positioning and have the beads stabilized enough to place the patient onto the splint without pushing the beads to one side. With the correct amount of evacuation, the splint surface should be smooth, but not dimpled.

POSITIONING AND APPLICATION

There are multiple methods for stabilizing a patient in the FASPLINT HALFBACK and preparing the patient for transport. The preferred option is to use a CombiCarrierII® or a scoop stretcher as a transfer means, thus minimizing the amount of movement of the patient. Other methods would include a multi-person lift or a log roll procedure. A variety of patient handling devices can be used with the FASPLINT HALFBACK. **Always follow your local medical protocols dictated by your medical director.**

Method #1: CombiCarrierII or Scoop Stretcher

1. Place a semi-rigid FASPLINT HALFBACK splint near the patient.
2. Apply the CombiCarrierII or scoop-type stretcher to the patient and use it to lift and transfer the patient onto the splint.
3. Position patient so their head is in the “head” circle and very close to the top edge of the splint.
4. Remove the scoop-type stretcher from around the patient and proceed with application of the splint (Steps 5-10).

Method #2: Log Roll

1. Place a semi-rigid FASPLINT HALFBACK splint on a backboard or other patient handling device.
2. Holding the splint in place on the backboard or other patient handling device, log roll the patient onto the device with the splint beneath them using standard patient care techniques.
3. Position patient so their head is in the “head” circle and very close to the top edge of the splint.
4. Proceed with application of the splint (Steps 5-10).

For Both Methods:

5. If the splint was semi-rigid, open the MaxiValve, allowing air to enter the splint. Keep the valve open until the splint softens and begins to conform to the shape of the patient. Make sure there are sufficient beads to maintain neutral alignment of the patient. If necessary, pad appropriately to ensure neutral alignment. **Always follow the protocols established by your medical director.**
6. Shape the splint around the sides of the patient’s head, making sure to fill the voids by the shoulders and the neck of the patient. Do not shape the splint around the top of the head. Continue to hold these “head blocks” that you have formed until the splint is evacuated. A second person should hold the sides of the splint up to the hips of the patient until the splint is evacuated to ensure the splint conforms to this area, as well. Form the FASPLINT HALFBACK to meet the needs of the patient, using additional rescuers if required. Some patients may be more comfortable with their knees slightly flexed. If this positioning is desirable, you will need to use additional padding or an additional FASPLINT to support the patient’s legs in a flexed position.



APPLICATION GUIDELINES

7. Evacuate the air from the FASPLINT HALFBACK® using the valve located at the head end. Under normal conditions, the manual vacuum pump may require up to 20 strokes to achieve rigid immobilization. At higher altitudes (4,000 ft. +), it may be necessary to use 25-30 strokes to completely evacuate the splint.
8. To prevent accidental valve opening, whenever a patient is being moved in the splint or when the splint is being put away, make sure to **ALWAYS** place the **RED LEASHED CAP** over the end of the MaxiValve™.
9. Finish securing the patient's head using medical-grade adhesive tape as dictated by your local medical protocols.
10. Secure the patient in the splint to your patient handling device using the strap configuration best suited to the patient's injuries and your local medical protocols. Always use caution when tightening patient restraint straps to avoid respiratory compromise or application of pressure to any injured area. Check the patient's neurovascular status and re-check all patient restraints prior to lifting or moving the patient. **Always follow your medical director's protocols when using the FASPLINT HALFBACK and when securing any patient restraints.**

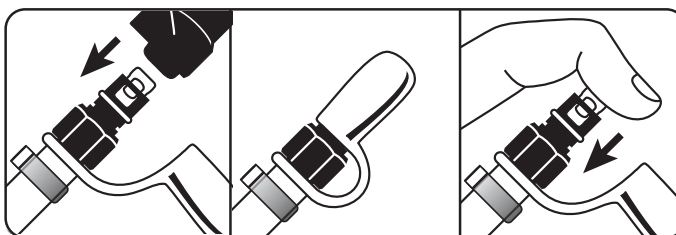

IMPORTANT NOTES

CAUTION! Lift the FASPLINT HALFBACK with a patient handling device as dictated by your protocols and with sufficient properly trained personnel that can support the weight of the patient stabilized in the FASPLINT HALFBACK splint. **Follow your local medical protocols regarding safe transfer and transportation of patients stabilized in the FASPLINT HALFBACK.** Always check the rigidity of the splint and verify that the patient is properly secured as dictated by your local medical director prior to moving the patient on or off of an ambulance cot or other patient handling device.

The splint is X-ray lucent. The MaxiValve is plastic with an internal stainless-steel spring.

HARTWELL MEDICAL WARRANTY

The FASPLINT HALFBACK splint has a one-year limited warranty against defects in material and workmanship. The MaxiValve is guaranteed for the life of the splint. Please register your product by filling out the warranty registration form online at www.HartwellMedical.com or by calling Customer Service. Should you require service under the terms of this warranty, contact your local Hartwell Medical Dealer or Hartwell Medical Customer Service during normal business hours. Hartwell Medical accepts no liability for use other than the uses set forth herein.

DOCUMENTATION OF TRAINING

Everyone who will be using or operating the FASPLINT HALFBACK® splint should be required to actively participate in the initial training and all subsequent refresher training sessions. This will ensure a clear understanding of the function and capabilities of the FASPLINT HALFBACK splint. You should utilize the training process that has been approved by your organization and is in accordance with your medical director's guidelines. Important items to document should be the training date, names of attendees, the instructor's name and title, and the training location.

MAINTENANCE LOG

Routine inspection and maintenance is required to keep the FASPLINT HALFBACK® splint ready for immediate use. If, at any time, the FASPLINT HALFBACK splint is suspected of not functioning properly it should be taken out of service until such time that it can be thoroughly inspected and properly repaired or replaced. As part of your preventative maintenance program, you should maintain a written log of any maintenance performed on the FASPLINT HALFBACK splint.



FASPLINT HALFBACK®

APPLICATION GUIDELINES

CLEANING AND MAINTENANCE

The FASPLINT HALFBACK splint is easily cleaned using soap and water, a mild detergent, or a commercial cleaner/disinfectant. **ALWAYS** place the red leashed cap on the end of the MaxiValve before cleaning the splint. Sodium hypochlorite (bleach) solutions may be used, but avoid prolonged exposure of the splint to high concentrations of bleach because discoloration is possible. A 1% bleach solution is recommended by the Centers of the Disease Control (CDC). **ALWAYS** rinse the splint thoroughly after cleaning. Allow the splint to air dry or towel dry before placing it in its storage/carry case. Check the splint for leaks after each use.

REPAIR

If you have a need to patch your FASPLINT FULLBODY® mattress or splint product you may find Peel and Stick Patches for Vacuum Splints patches easy to use and quick to apply. Read ALL directions before applying a patch.

For best results wash and dry your hands before applying the patch. Apply to a clean, dry surface. Surface temperature of the materials to be repaired should be 50° F or warmer. The splint should be soft, not evacuated. Move the beads inside of the vacuum splint or mattress away from the area to be patched, creating as flat an area of fabric as possible. These patches are designed for and will provide the best results for use on small holes or cuts that are 1/4" or LESS in length.

STEP 1. CLEAN & DRY: Clean the surface to be repaired with an alcohol prep pad or a 50/50 mixture of rubbing (isopropyl) alcohol and water. Before proceeding, make sure the surface is completely dry.

STEP 2. PEEL: Carefully peel back half of the paper liner, touching just the edges or corners of the patch.

STEP 3. STICK: Position and anchor the exposed portion of the patch. Position the patch so the small hole or tear will be in the center area of the patch. Slowly peel back the rest of the liner while carefully applying the patch over the small hole – take care to avoid air bubbles. Smooth out the patch working from the center of the patch to the outside edges of the patch. Rub all edges to seal the patch and then rub the entire patch aggressively. Let the splint or mattress sit, undisturbed and not evacuated for one hour. Repair is now complete.

ALWAYS TEST THE PRODUCT BEFORE PLACING IT BACK IN SERVICE. Do not place repaired products into a washer or dryer. For best results, store patch material at room temperature.

Note: Temporary field repairs can be made using a small piece of nonporous adhesive tape or duct tape placed over the damaged area. If you have any questions about these repair procedures please contact us directly at 760-438-5500 or customerservice@hartwellmedical.com.

Additional repair kits can be ordered online at
www.HartwellMedical.com

HARTWELL MEDICAL



Tri-Tech Forensics, Inc. dba Hartwell Medical
3811 International Blvd NE, Suite 100
Leland, NC 28451 USA
PH: (760) 438-5500
www.HartwellMedical.com



MedEnvoy Global B.V
Prinses Margrietplantsoen 33
Suite 123
2595 AM The Hague
The Netherlands